

THE SOTERIAN SLIM

THE SOTERIAN TS008 LETTERPLATE

Named after the Goddess of Safety, the Soterian Slim letterplate is stylish, streamlined and secure. It is the ultimate TS008 certified letterplate, made to protect and perfect your door. Its extreme compactness is what sets it apart from anything else currently on the market.

CERTIFIRE APPROVED

The Soterian Slim TS008 letterplate has achieved Certifire approval from Warringtonfire Testing & Certification Limited. The letterplate is approved for use with FD30 timber doorsets.

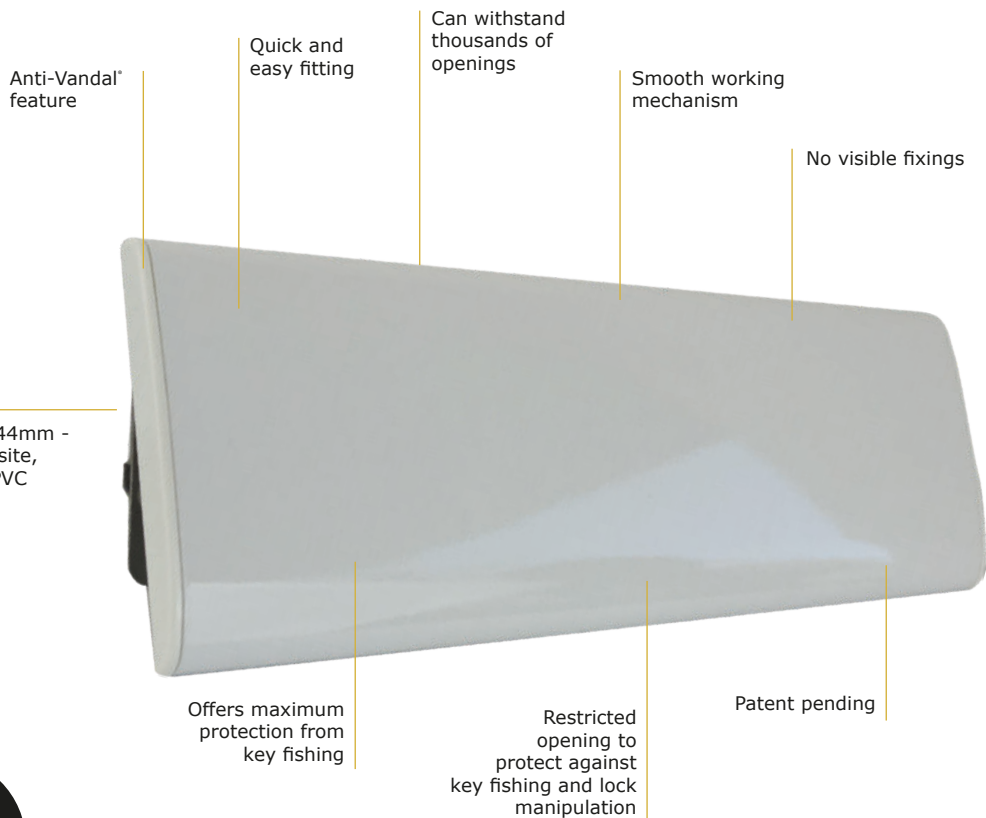

Most Compact TS008 on the market

Full unrestricted door opening – minimal internal flap projection of only 35mm from the door falls within the end of the door handle meaning the door will open FULLY without the letterplate stopping it doing so

MIX AND MATCH SOLUTION

Our revolutionary mix and match solution gives you the freedom to choose what finish you want for the internal and external frame. Whether it is a black inner frame with a white outer frame, or a traditional gold inner flap and gold outer flap – the choice is yours! Choose from 6 different finishes chrome, gold anodised, silver anodised, polished silver, black and white.



THE SOTERIAN SLIM

Soterian Slim TS008 FD30 Specification for Timber Doors:

Finish	Internal Frame Code*	External Frame Code	Flap Material Construction	Coating Guarantee
Satin Silver	TS008-SLIM-INTERNAL-SILVER-CERTIFIRE(V)-FD30	TS008-EXTERNAL-SILVER-FR	Aluminium & Stainless Steel	5 Years Inland
Satin Chrome	TS008-SLIM-INTERNAL-SATINCHROME-CERTIFIRE(V)-FD30	TS008-EXTERNAL-PS-FR	Aluminium & Stainless Steel	5 Years Inland
Chrome	TS008-SLIM-INTERNAL-CHROME-CERTIFIRE(V)-FD30	TS008-EXTERNAL-PVDG-NANOCOAST-FR	Aluminium & Stainless Steel	5 Years Inland
PVD Gold	TS008-SLIM-INTERNAL-PVDG-CERTIFIRE(V)-FD30	TS008-EXTERNAL-CHROME-FR* or TS008-EXTERNAL-MPSS-NANOCOAST-FR	Aluminium & Stainless Steel	5 Years Inland
White	TS008-SLIM-INTERNAL-WHITE-CERTIFIRE(V)-FD30	TS008-EXTERNAL-WHITE-FR	Aluminium & Stainless Steel	5 Years Inland

* Internal use only

Measurements

Distance Between Screw Holes	277mm
Letterplate Length	305mm
Letterplate Height	58mm
Frame Material	Aluminium
Cavity Hole Size	259mm x 48mm



Satin Silver



PVD Gold

Internal Frame



Satin Chrome



Chrome



White

External Frame



Satin Stainless



MPSS



PVD Gold



White

5 Steps Easy Fit

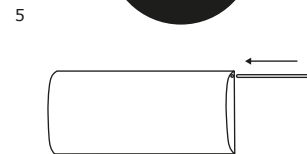
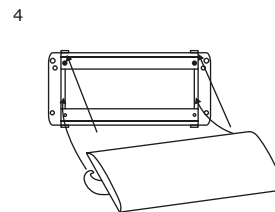
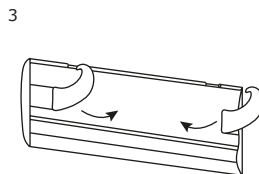
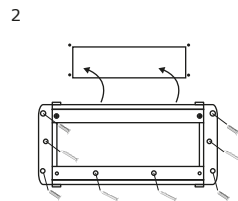
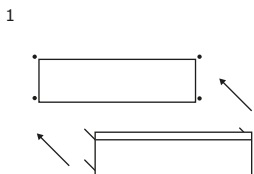

Less than 2min fitting time!