

## Crimebeater Lock with Additional Mid-Lock

### Lever-pad and lever-lever split spindle operation

The Crimebeater Mid-Lock is the only lock that not only locks the door but also locks the lock and meets the stringent security standards set out by ACPO Secured by Design initiative and the industry standards PAS 23:1-1999 & PAS 24:2007.

### Operation

#### To Lock Door

- Lift handle to its full extent (Fig 1.)
- Turn key or thumb turn one revolution towards door frame (Fig 2.)
- Insert the second key into the key hole above the handle turn one revolution towards door frame (Fig 3.)



Fig 1.



Fig 2.



Fig 3.

#### To Unlock Door

##### From Outside

- Insert the key into the key hole above the handle and rotate one revolution away from the door frame. Remove key (Fig 4.)
- Insert key into the key hole in the handle. Turn key one revolution away from door frame (Fig 5.)
- Push handle down (Fig 6.)
- Turn key once again to withdraw latch and push the door open.



Fig 4.

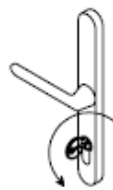

Fig 5.



Fig 6.

##### From Inside

- Insert the key into the key hole above the handle and rotate one revolution away from the door frame. Remove key (Fig 4.)
- Insert key into the key hole in the handle. Turn key one revolution away from door frame (Fig 5.)
- Push handle down and open door (Fig 6.)

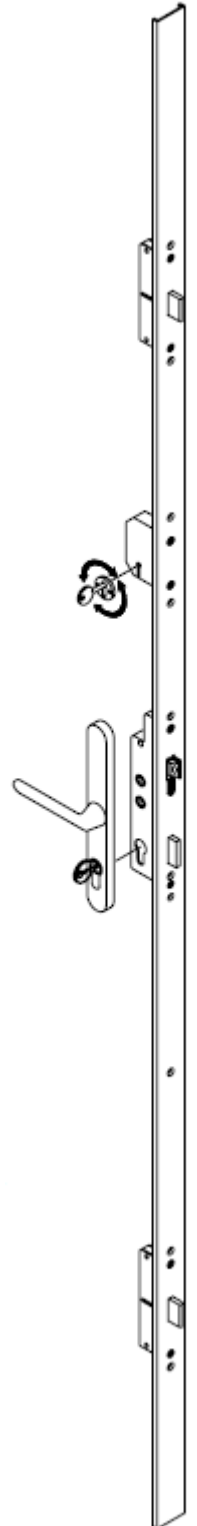
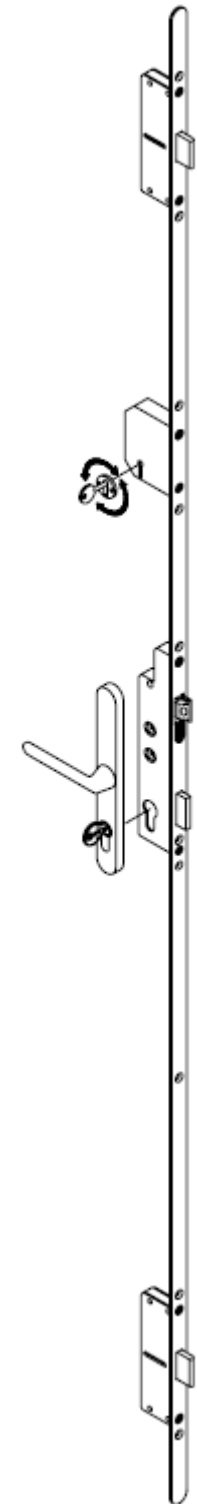

## Crimebeater Lock with Additional Mid-Lock

### Solid spindle operation

The Crimebeater Mid-Lock is the only lock that not only locks the door but also locks the lock and meets the stringent security standards set out by ACPO Secured by Design initiative and the industry standards PAS 23:1-1999 & PAS 24:2007.

### Operation

#### To Lock Door

- Lift handle to its full extent (Fig 1.)
- Turn key or thumb turn one revolution towards door frame (Fig 2.)
- Insert the second key into the key hole above the handle turn one revolution towards door frame (Fig 3.)



Fig 1.



Fig 2.



Fig 3.

#### To Unlock Door

##### From Outside

- Insert the key into the key hole above the handle and rotate one revolution away from the door frame. Remove key (Fig 4.)
- Insert key into the key hole in the handle. Turn key one revolution away from door frame (Fig 5.)
- Push handle down (Fig 6.)



Fig 4.

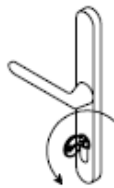

Fig 5.



Fig 6.

- Insert the key into the key hole above the handle and rotate one revolution away from the door frame. Remove key (Fig 4.)
- Insert key into the key hole in the handle. Turn key one revolution away from door frame (Fig 5.)
- Push handle down and open door (Fig 6.)